



df  
NH1 gS  
250 A  
550 VDC  
I<sub>n</sub>=30 kA Battery  
IEC/EN 60269-4  
370270  
RoHS COMPLIANT CE  
Made in Spain

df  
440 mA  
1000 V AC  
I<sub>n</sub>=30 kA

41601  
DMM F  
VDC

df  
10 x 150  
415130  
Spain

df  
10 x 85  
415035  
Spain

df  
440 mA  
1000 V AC  
I<sub>n</sub>=30 kA

df  
10 x 85  
Spain

battery storage  
multimeter  
public lighting

# SPECIAL FUSES

# SPECIAL FUSES

## NH BATTERY PROTECTION FUSE-LINKS

### DC NH BATTERY PROTECTION FUSE-LINKS

440V  
550V

The use of batteries is growing due to the utilization in renewable installations. These batteries shall be appropriately protected against overcurrents that could shorten its life, specially against short-circuits, that shall be interrupted in a very short time. NH BATTERY fuse-links from DF Electric are capable to clearing all types of overcurrents, overloads and short-circuits, thus the fuse-links protect the batteries as well as cables and all switchgear of installation. These fuse-links are designed and manufactured with the same techniques that semiconductor fuse-links, which makes them very fast of operation and gives a good performance under continuous charge / discharge cycles. They are optimized to have reduced power dissipations that allow the utilization of a wide range of fuse-bases, disconnectors and fuse-switch-disconnectors. NH BATTERY fuse-links range comprise five sizes NH000, NH00, NH1, NH2 and NH3 with rated currents between 20A and 630A, with working voltages up to 440 V DC and 550 V DC. These fuse-links can be used also as a protection in other DC applications, but it is very important to take into account the kind of load and the time-constant of circuit in order to have a correct application (consult us).

	I <sub>n</sub> (A)	REFERENCE	U (V DC)	BREAKING CAPACITY (kA DC)	PACKING Uni./BOX
<b>NH000</b>	20	370025	440	30	3/90
	25	370030	440	30	3/90
	32	370035	440	30	3/90
	40	370045	440	30	3/90
	50	370050	440	30	3/90
	63	370055	440	30	3/90
	80	370060	440	30	3/90
	100	370065	440	30	3/90

<b>NH00</b>	125	370070	440	30	3/60
	160	370075	440	30	3/60

<b>NH1</b>	200	370260	550	30	1/30
	250	370270	550	30	1/30
	280	370273	550	30	1/30

<b>NH2</b>	315	370370	550	30	1/20
	355	370375	550	30	1/20
	400	370380	550	30	1/20
	450	370387	550	30	1/20

<b>NH3</b>	500	370465	550	30	1/15
	630	370470	550	30	1/15



# SPECIAL FUSES

## NH BATTERY PROTECTION FUSE-LINKS

TECHNICAL

### NH BATTERY PROTECTION FUSE-LINKS DIMENSIONS

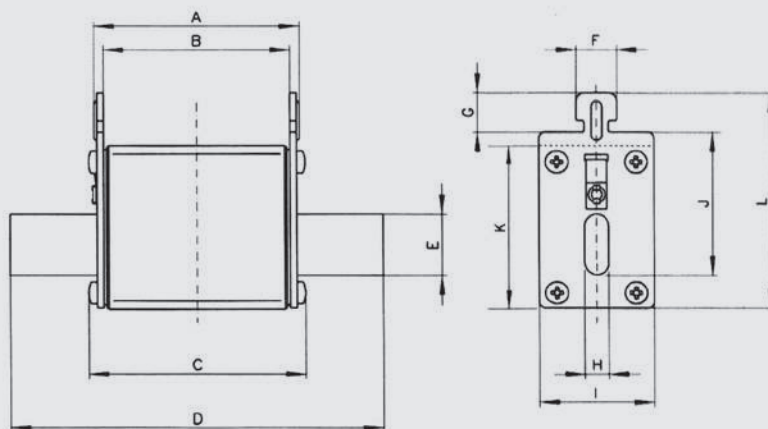

SIZE	A	B	C	D	E	F	G	H	I	J	K	L
NH000	49	45	52	78,5	15	10	9,5	6	21	35	40	53
NH00	49	44	52	78,5	15	10	9,5	6	29	35	47	59
NH1	68	62	71,5	135	20	10	9,5	6	39	40	52	64
NH2	68	62	71,5	150	25	10	9,5	6	53	48	60	72
NH3	68	62	73	150	32	10	9,5	6	70	60	75	87

TECHNICAL

### NH BATTERY PROTECTION FUSE-LINKS t-I CHARACTERISTICS

